

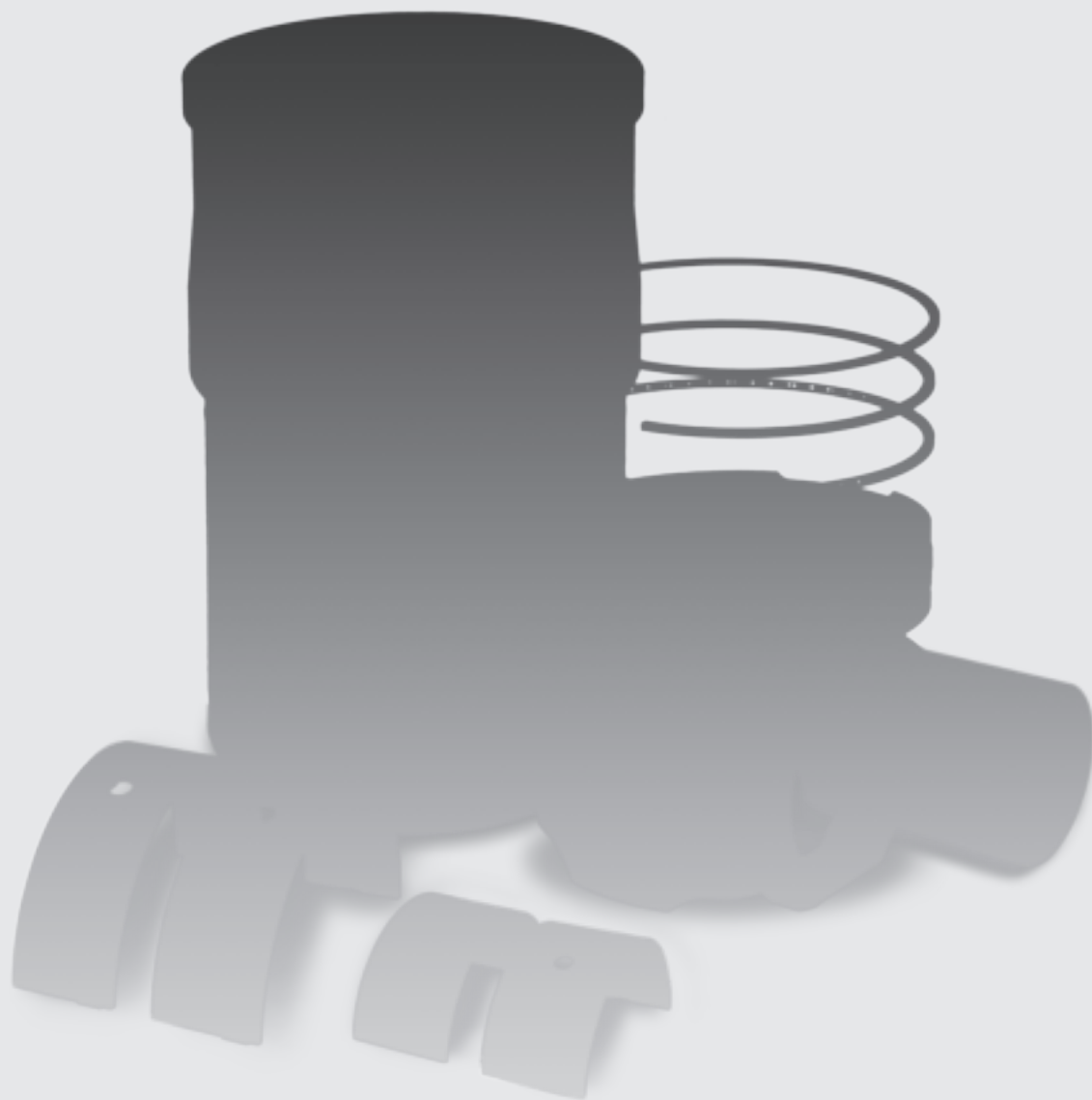

Cummins Warranty

Repaired Components Warranty



Coverage

This Warranty Coverage is effective on September 1, 2017 and pertains only to the Cummins Electronic Control Module (ECM) Part Numbers 3619037FR, 3618046FR, 3084473FR repaired after this date.

Products Warranted

This Warranty applies to the Cummins Electronic Control Module (ECM) Part Numbers 3619037FR, 3618046FR, 3084473FR repaired by Cummins Inc.

Base Engine Warranty

This Warranty covers any failures of repaired ECMs which result, under normal use and service, from defects in Cummins material or factory workmanship. This Coverage extends for six months, unlimited mileage/ hours of operation, from date of invoice.

Cummins ReCon® Responsibilities

Cummins ReCon® will pay for repair of the failed Electronic Control Module as a result of a Warrantable Failure.

Only parts and assemblies remanufactured by Cummins ReCon® or new genuine Cummins parts and assemblies will be used in making the repair.

Cummins ReCon® will pay for the shipping and handling to ship the ECM to the Cummins factory location and back to the Cummins authorized service provider as a result of a Warrantable Failure.

Owner Responsibilities

Owner is responsible for the operation and maintenance of the Engine as specified in the applicable Cummins Operation and Maintenance Manuals.

At the time Cummins repaired ECM is received, owner is responsible for the preparation of a written record containing the following:

- 1 the date of receipt of the ECM
- 2 the Engine serial number
- 3 the Engine miles, hours, or kilometers of operation

The purpose of this record is to protect the owner's interests and to support any claim for a Warrantable Failure.

Owner is responsible for delivering a failed ECM that is within its coverage period to a Cummins Distributor for failure analysis and repair before the expiration of the Warranty.

Owner is responsible for all labor, travel, towing, communication expenses, meals, lodging and similar

costs incurred by owner as a result of a Warrantable Failure.

Owner is responsible for "downtime" expenses and all business costs and losses resulting from a Warrantable Failure.

Owner is responsible for actual shipping and handling charges for shipping a failed ECM to the Cummins factory location and back to the Cummins authorized service provider if failure is determined to be non-warrantable.

Cummins ReCon® is not responsible for incidental or consequential damages.

Limitations

Cummins ReCon® is not responsible for failures resulting from owner or Operator abuse or neglect, such as: operation without adequate coolant, fuel or lubricants; over fueling; over speeding; lack of maintenance of lubricating, cooling or air intake systems; improper storage, starting, warm-up, run-in or shutdown practices; defective electrical wiring, electrical harness, electrical connectors, batteries or other related electrical components which caused the Electrics to fail or improper installation or misapplication, such as installing a 12 volt component on a 24 volt system.

This Warranty does not cover maintenance items, excessive labor or call-out charges.

Only Cummins ReCon® Parts are to be used in making Warranty repairs unless authorized by Cummins ReCon® Product Support.

Cummins Inc. reserves the right to interrogate Electronic Control Module (ECM) data for purposes of failure analysis.

These Warranties are the sole Warranties of Cummins ReCon® applicable to repaired products. Cummins ReCon® makes no other Warranties, express or implied, or of merchantability or fitness for a particular purpose.

These Warranties are made to owners in the chain of distribution and to the first retail purchaser only. They do not extend to subsequent purchasers.

* Service locations are listed on the Cummins Worldwide Service Locator at cummins.com.



Cummins Inc.
Box 3005
Columbus, IN 47202-3005
U.S.A.

Bulletin 5410966
Printed in U.S.A. Rev. 12/17
©2017 Cummins Inc.